

Garage

Mark out lower deck (1), upper deck (2) side wall (3), central wall (4), back and front walls (5) and low wall (6) on sheet of $\frac{1}{4}$ in. thick plywood, to dimensions given in fig. 2.

Cut parts to size. Cut $2 \times \frac{1}{4}$ in. halving joints in upper and lower decks and side and front walls. Cut two $1 \times \frac{1}{4}$ in. halving joints on front edge of central wall and $1 \times \frac{1}{8}$ in. halving joint on back edge. Cut $1 \times \frac{1}{8}$ in. halving joint on low wall.

Cut ramp (7) from $\frac{1}{8}$ in. thick plywood, with grain of face veneers running along short side. Cut $\frac{1}{4}$ in. wide slots. Make saw cuts through face veneer only on underside as shown by dotted lines (fig. 2).

Cut strips of adhesive tape to width of halving joints and stick them on areas to be glued. Paint all surfaces with polyurethane lacquer. Remove tape when paint is dry but not hard.

Glue side wall, central wall and back and front walls into upper and lower decks.

Glue and pin front wall and lower deck to low wall, edges flush with side of low wall. Fill pin holes and touch up paint.

Make packing (8) by gluing $6\frac{1}{4} \times \frac{1}{2} \times \frac{1}{8}$ in. plywood strip to $6\frac{1}{4} \times 1 \times \frac{1}{8}$ in. plywood strip. Glue packing to underside of lower deck at edge between central and low walls. Make similar 3 in. long packing (9) for upper deck and trim thick part to slope of ramp (fig. 3). Glue packing to underside of upper deck.

Glue ramp into slots and to packing strips, springing it open to meet each deck. Glue ramp to sides of low wall. When glue is set, chamfer bottom end of ramp flush with bottom edge of wall.

Glue $\frac{1}{2} \times \frac{1}{4}$ in. cock bead barriers to open edges of decks and to ramp, $\frac{1}{4}$ in. from deck edges and flush with ramp edges. Paint beads to match deck.

Chamfer edges of $36 \times 30 \times \frac{1}{4}$ in. plywood base to acute angle to give easy run-up for cars. Fill end grain and paint base.

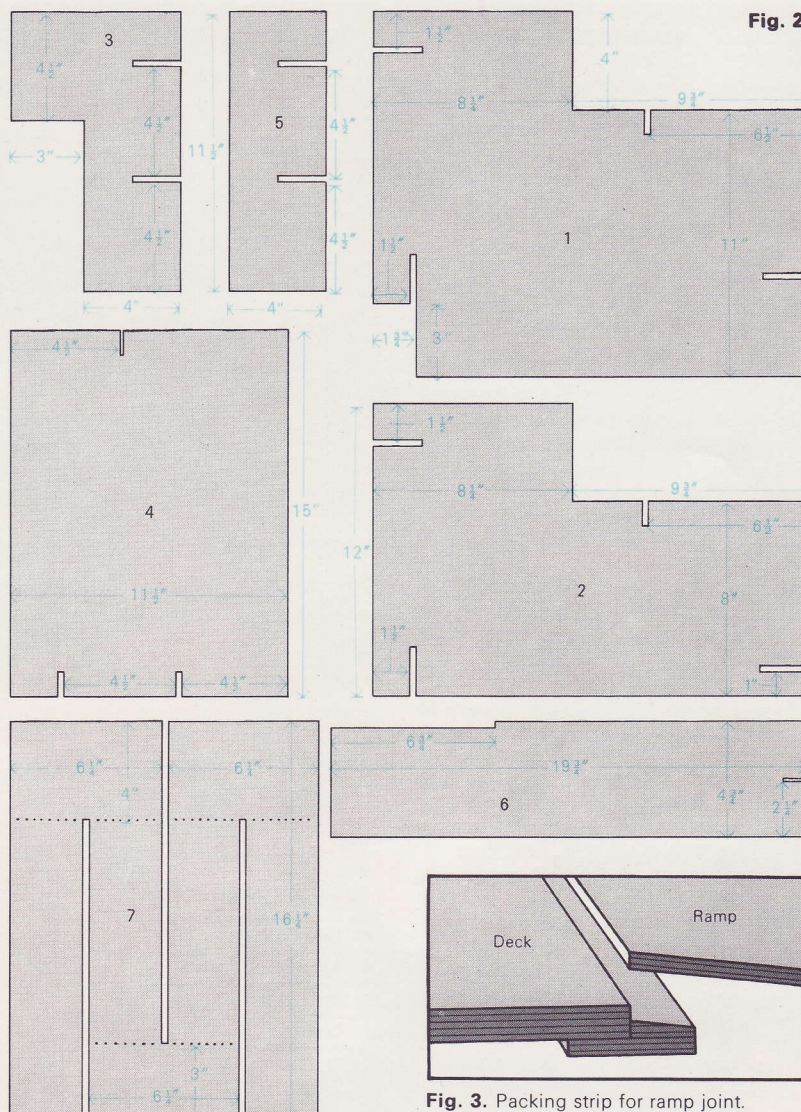

Fig. 2.

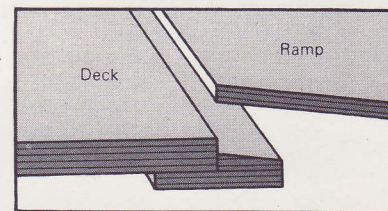

Fig. 3. Packing strip for ramp joint.

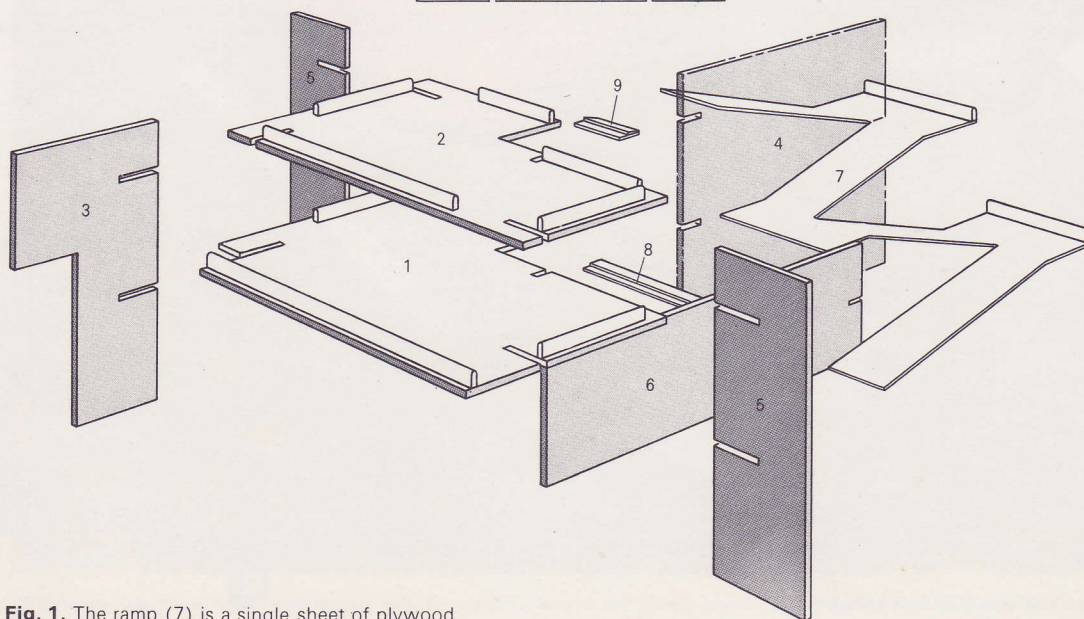
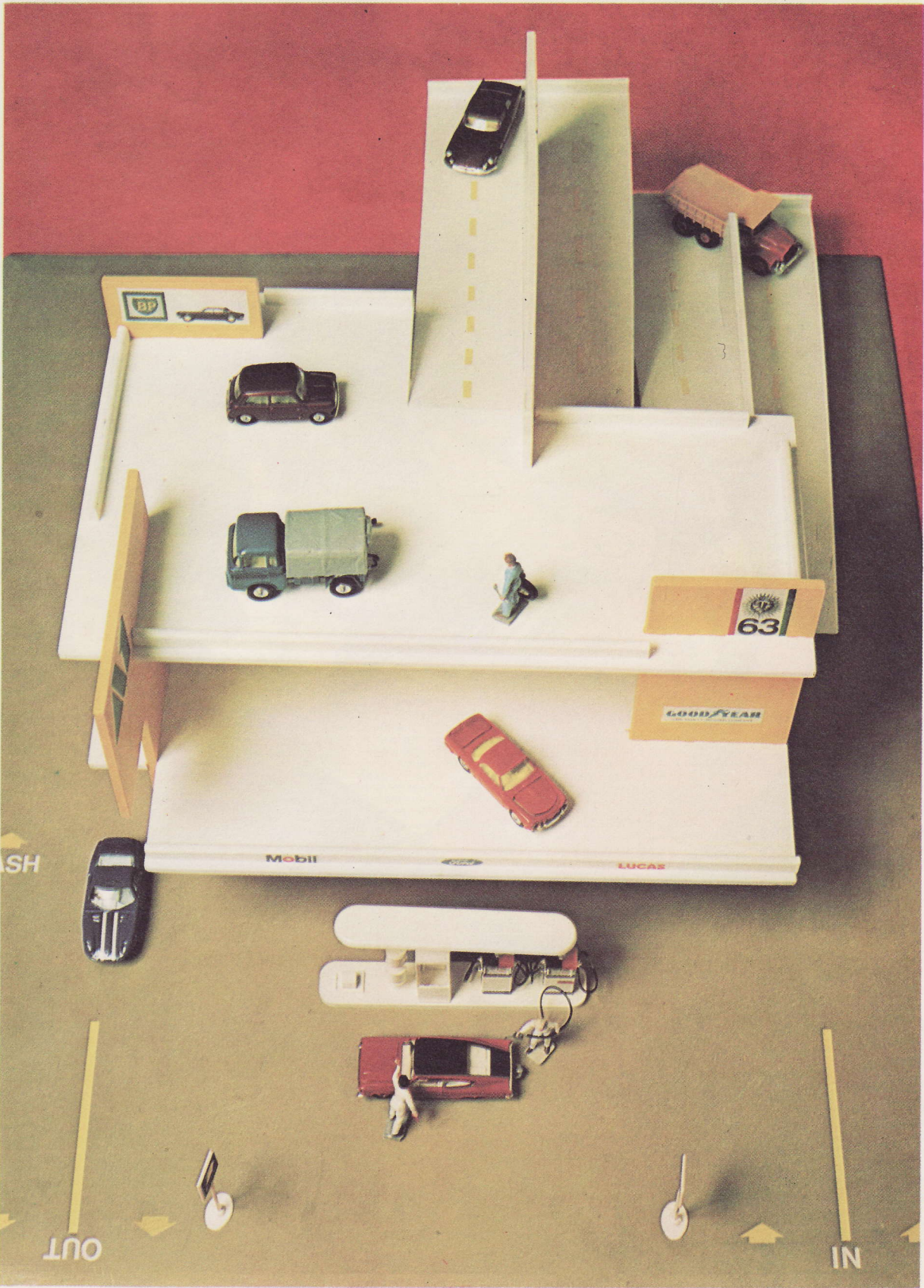

Fig. 1. The ramp (7) is a single sheet of plywood.

Garage/children's table and chairs



Children can decorate this garage with trade signs cut from advertisements. Letraset instant lettering is used on the forecourt.

Designer: David J. Day